

Ulti Roll Clean



HYGIENIC ANTI-DRIP RAPID DOOR FOR FOOD PROCESSORS

The Ulti Roll Clean is a high-speed, crash-resistant, low-maintenance and washable PVC fabric door that meets the stringent hygiene and wash-down requirements of the NZ food industry.

The Ulti Roll Clean is fully wash-down capable with stainless steel construction and a sloped hood with integrated anti-drip draining channel designed to prevent condensation and water from dripping down from the hood or door curtain into the doorway and spoiling your food product.



Ideal for use in

- Washdown Areas
- Highly Corrosive Applications
- Food Processing
- Hygienic environments
- Carwash
- Pharmaceutical
- Hospital
- Laboratories
- Chemical

Ulti-Mate Hygiene

The Ulti Roll Clean has an innovative design incorporating an anti-drip drain, that stops water from pooling and dripping on the food products, ensuring hygiene and quality.

Speed Where it Matters

With fast opening speeds of up to 2.5m/second the Ulti Roll Clean opens quickly and remains open for the minimum time required, maximising productivity, and decreasing the opportunities for contamination.

Low Maintenance

The innovative curtain edge that firmly holds the curtain into the side guides has continuous injection-moulded teeth that are held in a self-lubricating polyethylene track, meaning no chemicals needed for washing and maintenance. Because there are no metal parts within the curtain design, damage and downtime is also kept to a minimum.

Enhanced Environmental Control

The Ulti Roll Clean has a zipper edge that creates a well-sealed door, preventing air leakage and maintaining the optimal temperature and humidity for food production.

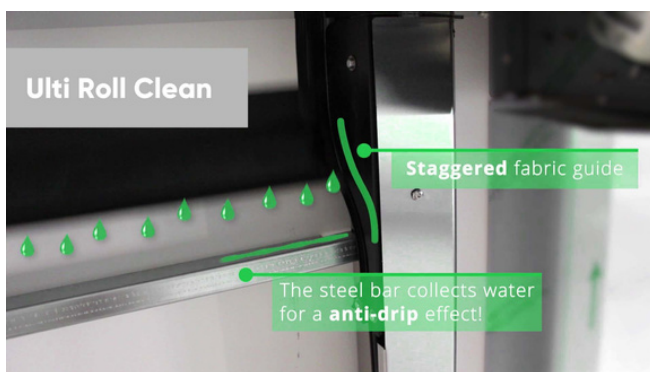

STANDARD COMPLIANCE

Wind Permeability	Class 2	Water Permeability	Class 1
Wind Loading	Class 3	Pressure Differential	Up to 50Pa
Thermal Transmittance	6.02 W/m ² K	Temperature Differential	20deg*
Safe Openings	Yes		

*Subject to Applications Review

TECHNICAL SPECIFICATIONS

Application	Internal Only
Standard Size	2000mm W x 3500mm H
Minimum Size	500mm W x 600mm H
Maximum Size	4000mm W x 4000mm H
Opening Speed	Up to 2.5m/s - variable
Closing Speed	0.8m/s - variable
Operating Temperature	-10°C to +50°C (<0°C requires heated frame)

STRUCTURE

Material	Stainless Steel AISI:314 frame structure and AISI:304 drive drum
Colour	Stainless Steel

CURTAIN

Material	Food Grade Curtain - FDA Approved (1700gr/m ²)
Colour	RAL9010
Vision Panels	1 row of large clear-vision panels

SPACE REQUIREMENTS

minimum clearances

Headroom	800mm
Sideroom	595mm* (motor side), 175mm (non-motor side) *Allowing for 200mm Maintenance Access

DIMENSIONS



FLOOR PLAN VIEW

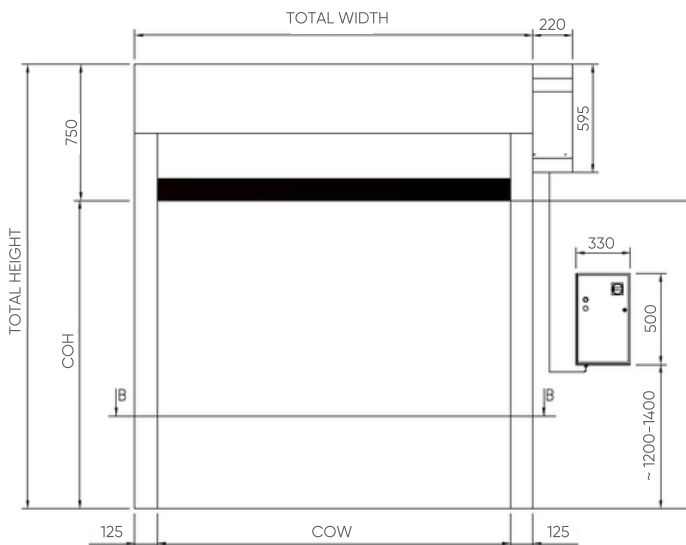

FRONT ELEVATION VIEW

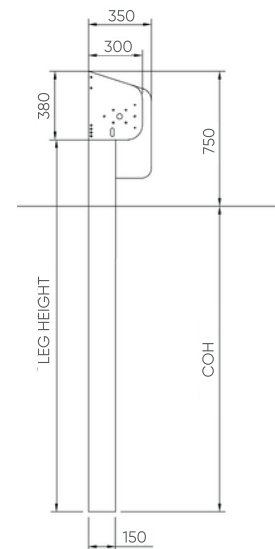

SIDE ELEVATION VIEW

MOTORISATION

Motor	IP65 Rated 1.5kW Motor with Stainless Brake (for corrosive applications)
Motor Position	RH Side
Control Panel	IP54 Corrosion Resistant AISI:304 Stainless Steel with inverter frequency controller
Power Supply	240V; single phase; 15Amp Rated; adjacent to control box, installed to RH side

ACTIVATIONS

Manual	Large Heavy-duty Mushroom Head push button Push button and Emergency stop button fitted to control box
--------	---

SAFETY

Standard	Soft PVC Bottom Edge Reversing Sensor System for obstructions to door curtain
>2500mm H Doors	2000mm H Tower Beam Safety Sensors IP67
<2500mm H Doors	Infrared Photocell Safety Beams IP65
Emergency Egress	Manual Hand Crank

STANDARD INCLUSIONS

Leg Cover, Hood Cover, and Motor Cover in Stainless Steel
15° Sloped Hood Cover for washdown applications
Patented Sliding System with high-density polyethylene, self-lubricating guides
Re-feed slot in guides
Encoder Control
Performance Rated to 1,000,000 Cycles

WARRANTY

12 Months or 100,000 Cycles
*Std Warranty Terms & Conditions Apply

OPTIONAL FEATURES

Activations	All Ulti activation options can be applied
Mounting Options	LH Power Supply, LH Motor, LH Control Box, Custom Control Box Position
Power Supply	9m ² < door size < 25m ² - requires heavy-duty single phase 240V 50Hz Control Box 400V; 3phase+N+E; 15Amp Rated; adjacent to control box
Heated Frame	240V door legs and motor heat tracing for Freezer applications (additional 10Amp power supply isolator required)
Curtain Colours (non FDA)	RAL1003, RAL1015, RAL2004, RAL3002, RAL5002, RAL5010, RAL5012, RAL6018, RAL6026, RAL7016, RAL7035, RAL7037, RAL7042, RAL8017, RAL9005, RAL9006, RAL9010
Curtain Design	Custom Printed Curtain
Vision Panels	2 Rows, Custom rows available
Emergency Egress	UPS Battery Backup (single phase)