

# Ulti Spiral Plus

## HIGH PERFORMANCE INSULATED SPIRAL DOOR

A high quality, fast, NZ-made insulated spiral door, maximising security, while maintaining the efficiencies of a short cycle time. Great for external applications, this low maintenance door ensures long term reliability.

### Speed Where it Matters

With opening and closing speeds of up to 2m/sec, this is one of the fastest insulated spiral doors available, reducing cycle times, and maximising energy savings, and productivity at your facility. The rapid-acting door ensures the security and integrity of your facility at all times – intruder proof, but fast.

### Energy Saving

The Ulti Spiral Plus has excellent thermal insulation, and acoustic properties, by using insulated dual-wall slats. This allows you to maximise your energy savings at even the biggest access points of your facility.



### Ideal for use in

- Foodgrade Warehousing
- Manufacturing Facilities
- Secure Institutions
- Government or Embassy
- Airports
- Car parking
- Apartment Parking
- Logistics

### Low Maintenance

The unique counterweighted drive system on the Ulti Spiral Plus, has no springs, and less moving parts, with a patented wheel-less, spiral track system. This means fewer maintenance headaches and more reliability, with an exceptional life span, giving you complete peace of mind, and maintenance savings. The slats of the Ulti Spiral Plus are guided in a spiral CNC routed groove, for fast opening speeds, low maintenance, and precise door travel. The no-contact spiral technology means there is no wear on the door sections, ensuring a great long-lasting appearance, and eliminating the transfer of dirt and grime from one panel to another.

### Safety Where it Matters

A Tower Beam Safety Sensor integrated into the Ulti Spiral Plus frame, monitors the closing zone of up to 2m high and reverses the door if any of the light beams are interrupted, meaning the door cannot close on any personnel, vehicle or object that might be in the door's path of travel.

### Customisable One Door System

By combining many features and benefits together into one door, the Ulti Spiral Plus removes the need to have both a slow secure roller shutter door and a high-speed fabric door in one doorway. You can also configure the door however you want by swapping out the solid core panels, with a ventilated option, or polycarbonate vision windows.



## STANDARD COMPLIANCE

Wind Permeability	Class 3	Water Permeability	Class 3
Wind Loading	Class 4 (up to 5000mm H x 5000mm W) Class 3 (more than 25m²)		
Acoustic Performance	22dB	Thermal Transmittance	1.5 W/m²k
Safe Openings	Yes	Pressure Differential	Up to 70Pa

## TECHNICAL SPECIFICATIONS

Application	Internal/External
Standard Size	4000mm H x 4000mm W
Minimum Size	1500mm H x 1500mm W
Maximum Size	6000mm H x 6000mm W
Opening Speed	Up to 2m/s
Closing Speed	0.5 m/s (variable)
Operating Temperature	-5°C to +40°C

## STRUCTURE

Material	Galvanised Steel
Colour	Galvanised

## SPACE REQUIREMENTS

### minimum clearances

Headroom	900mm < 4000mm H or 1300mm < 6000mm
Sideroom	400mm (motor and non-motor side)

## SLAT

Material	200mm H x 50mm D Dual Wall Aluminium Insulated Slats
Slat Colour	RAL9006

## DIMENSIONS

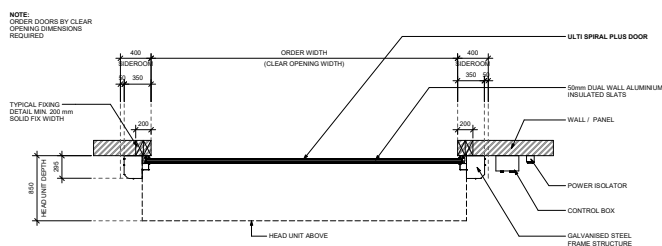

FLOOR PLAN VIEW

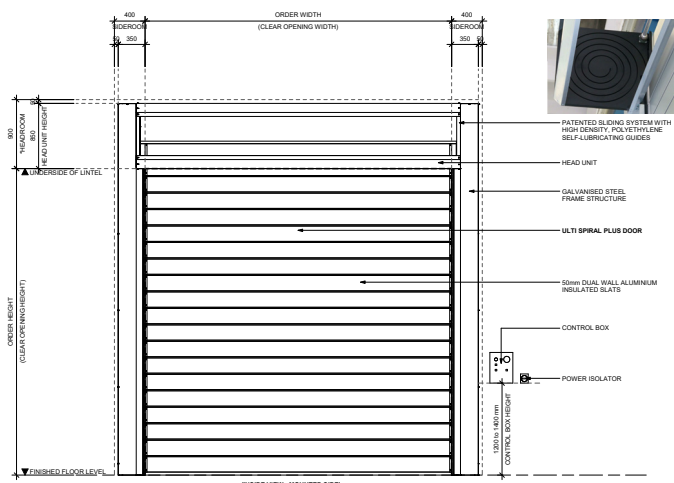

FRONT ELEVATION VIEW

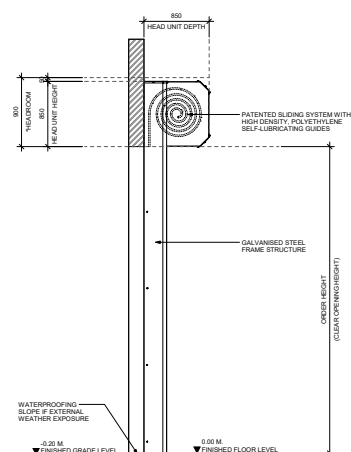

SIDE ELEVATION VIEW

## MOTORISATION

Motor	IP54 rated 2.2kW Heavy Duty 3phase Motor Drive and electromagnetic brake – RH mounted
Motor Position	RH Side
Control Panel	IP54 rated Metal Control box with inverter frequency controller – RH mounted
Power Supply	400V; 3phase+N+E; 15Amp Rated adjacent to control box installed to right hand side

## ACTIVATIONS

Manual	Large Heavy-duty Mushroom Head push button Push button and Emergency stop button fitted to control box
--------	---

## SAFETY

Standard Inclusions	2000mm high Tower Beam Safety Sensors IP67 when door height >2500mm LED Countdown Timer in Control box
Emergency Egress	Manual Hand Chain

## STANDARD INCLUSIONS

Variable speed control
Galvanised Leg Covers
Patented Spiral Header Unit
Patented sliding system with high density polyethylene, self-lubricating guides
Perimeter seal system
Encoder control
50mm Spacer Frame for doors >5500mm W
Performance rated to 1,000,000 cycles with Ulti Planned Maintenance every 3 months

## WARRANTY

24 Months or 100,000 Cycles
*Std Warranty terms and conditions apply

## OPTIONAL FEATURES

Activations	All Ulti Activation options can be applied
Mounting Options	LH Control Box, LH Power Supply, Custom Control Box Position
Hood & Motor Covers	Galv, Colour finished
Vision Panels	1, 2, or 3 rows, custom rows available
Ventilated Panel	1, 2, or 3 rows, custom rows available
Safety	Virtual Vision, Extended LED Countdown Timer