

NOTE:
CONTACT ULTI GROUP FOR ANY CUSTOMISATIONS AND TO DISCUSS PROJECT SPECIFIC INFORMATION

www.ultigroup.co.nz
hello@ultigroup.co.nz
Phone: 0800 807 753
105 Glover Road, Hawera, 4610

SPECIFICATIONS :

RELEASED VERSION NO. : **VERSION 1**

PRODUCT GROUP : **SECTIONAL DOORS**

PRODUCT ID : **00000**

APPLICATION : **INTERNAL & EXTERNAL**

STANDARD SIZE : **3000 mm WIDE x 3500 mm HIGH**

MINIMUM SIZE : **2000 mm WIDE x 2000 mm HIGH**

MAXIMUM SIZE : **8000 mm WIDE x 6000 mm HIGH**

HEADROOM : **500 mm**

SIDE ROOM - MOTOR SIDE : **295 mm**

SIDE ROOM - NON MOTOR SIDE : **120 mm**

STANDARD FRAME MATERIAL : **GALVANISED STEEL**

STANDARD FRAME COLOUR : **GALVANISED FINISH**

STANDARD PANEL MATERIAL : **60 mm THICK THERMO PANELS WITH MICRO PROFILE EXTERIOR**

PANEL COLOUR (INSIDE / OUTSIDE) : **RAL 9002 - STANDARD**

VISION PANELS : **STANDARD RECTANGULAR TRIPLE GLAZED VISION PANEL (680 mm x 370 mm)**

POWER SUPPLY : **3 PHASE, 400V + NEUTRAL + EARTH 16 Amp 50 Hz**

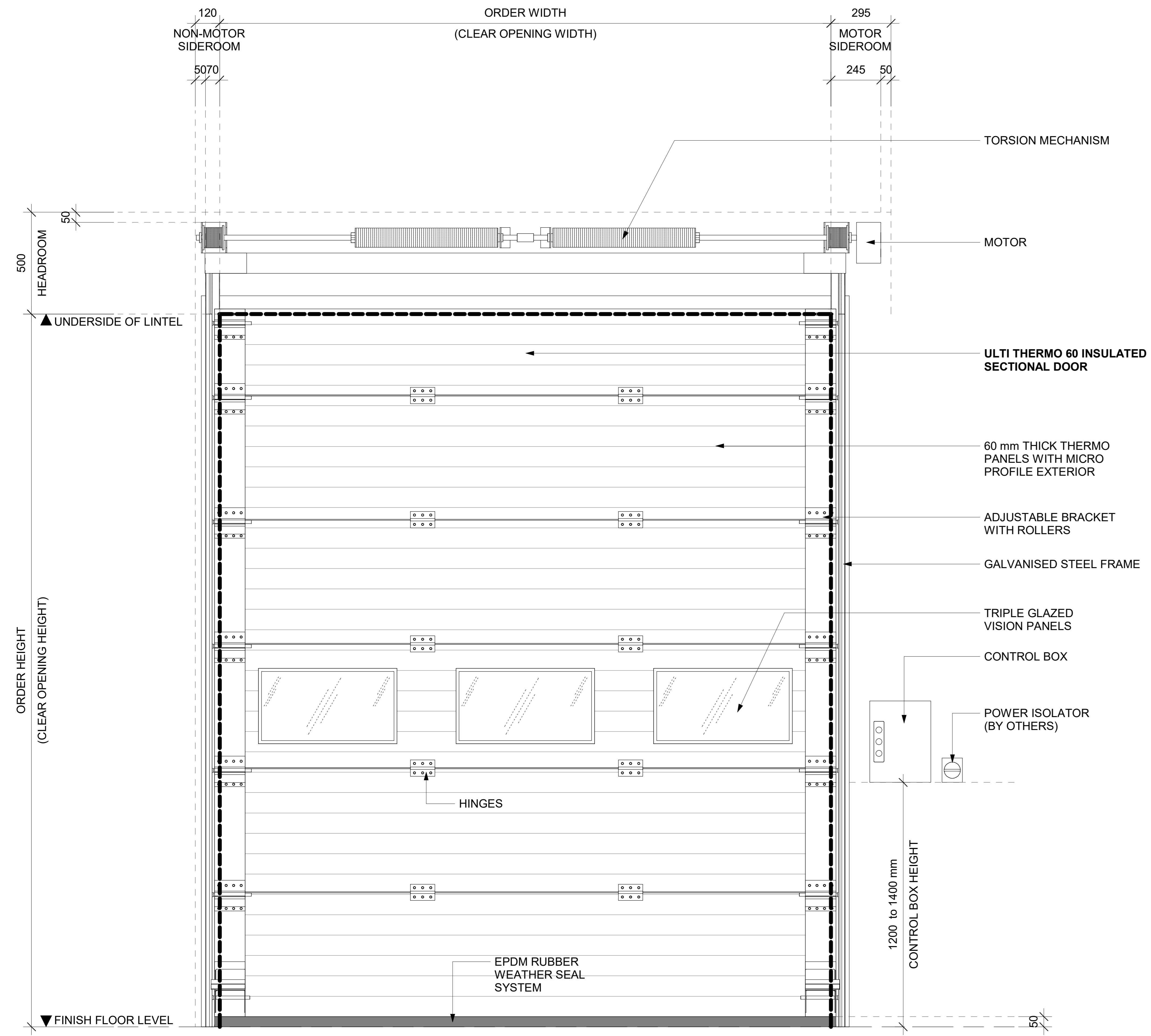

1 FRONT ELEVATION VIEW
SCALE: 1:10 MTS.

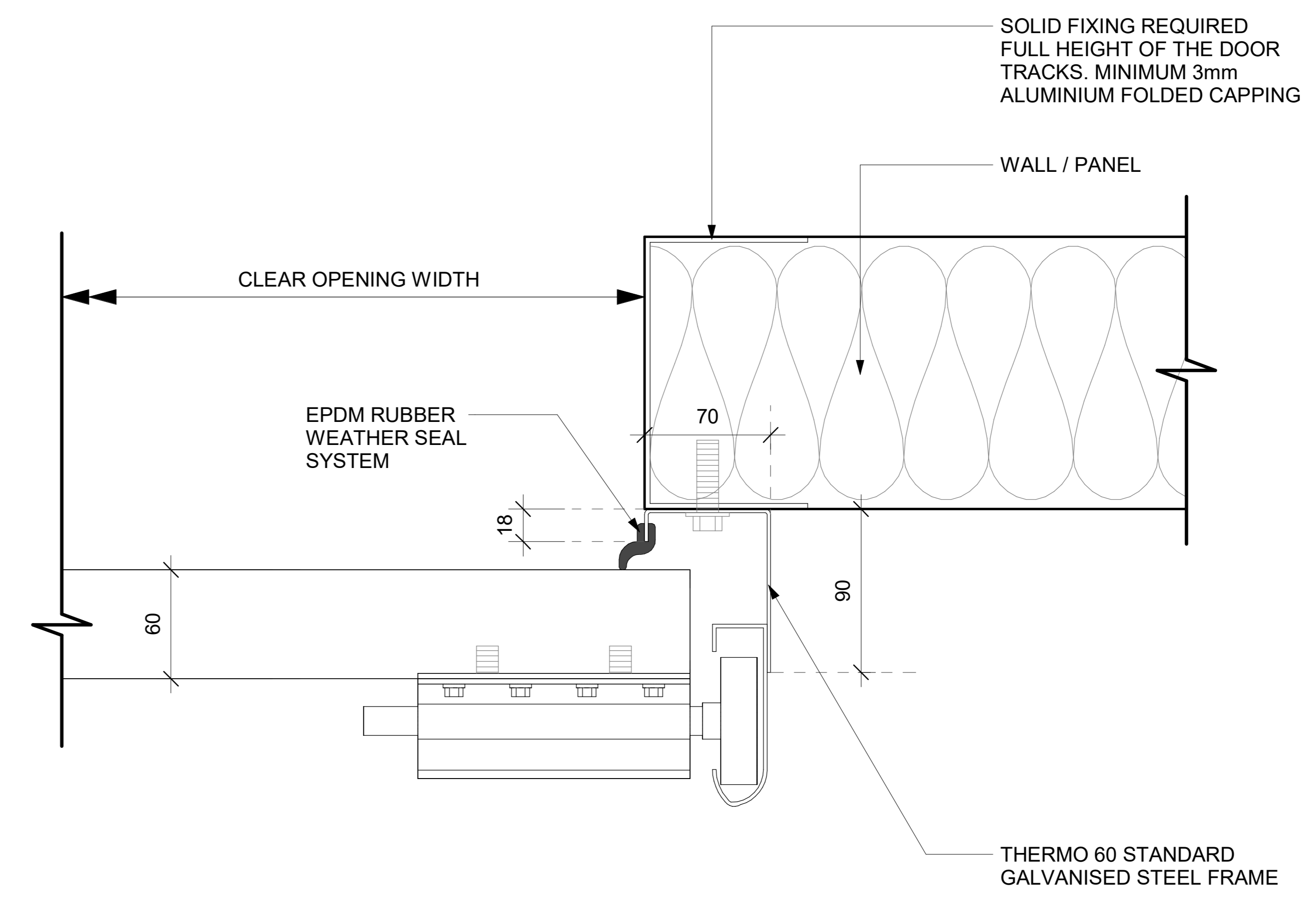

3 BLOW-UP PLAN DETAIL
SCALE: 1:2 MTS.

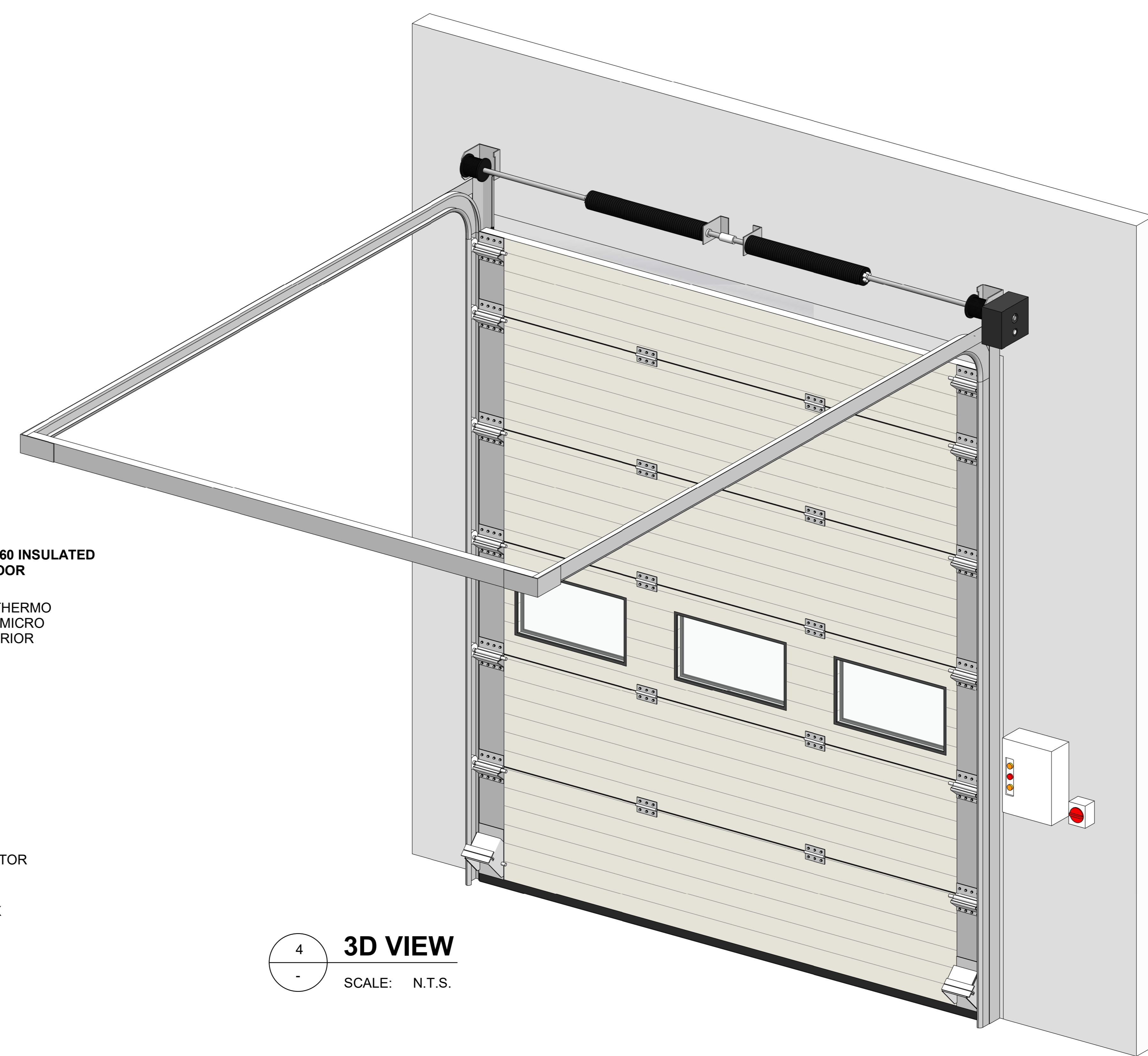

4 3D VIEW
SCALE: N.T.S.

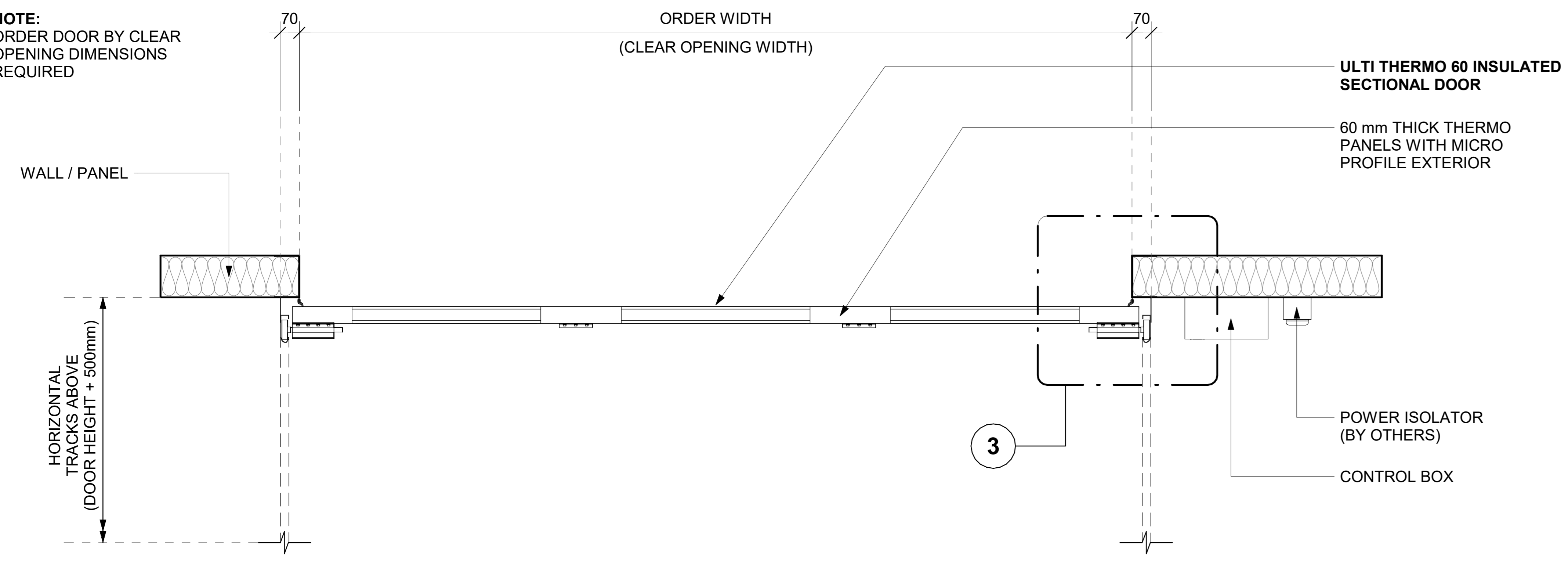

2 FLOOR PLAN VIEW
SCALE: 1:10 MTS.

TITLE:
ULTI THERMO 60 INSULATED SECTIONAL DOOR - STANDARD LIFT

SHEET NO. : 1 OF 1
DATE : NOV. 15, 2021

DRAWING NUMBER :
THERMO60-SECT-STD-001

APPROVED BY : J.PRESTIDGE
DRAWN BY : J.ENRIQUEZ

SCALE : As indicated
SHT. SIZE : A0

*All dimensions are in millimeters unless otherwise specified