

NOTE:

CONTACT ULTI GROUP FOR ANY CUSTOMISATIONS AND TO DISCUSS PROJECT SPECIFIC INFORMATION

www.ultigroup.co.nz
hello@ultigroup.co.nz
Phone: 0800 807 753
105 Glover Road, Hawera, 4610

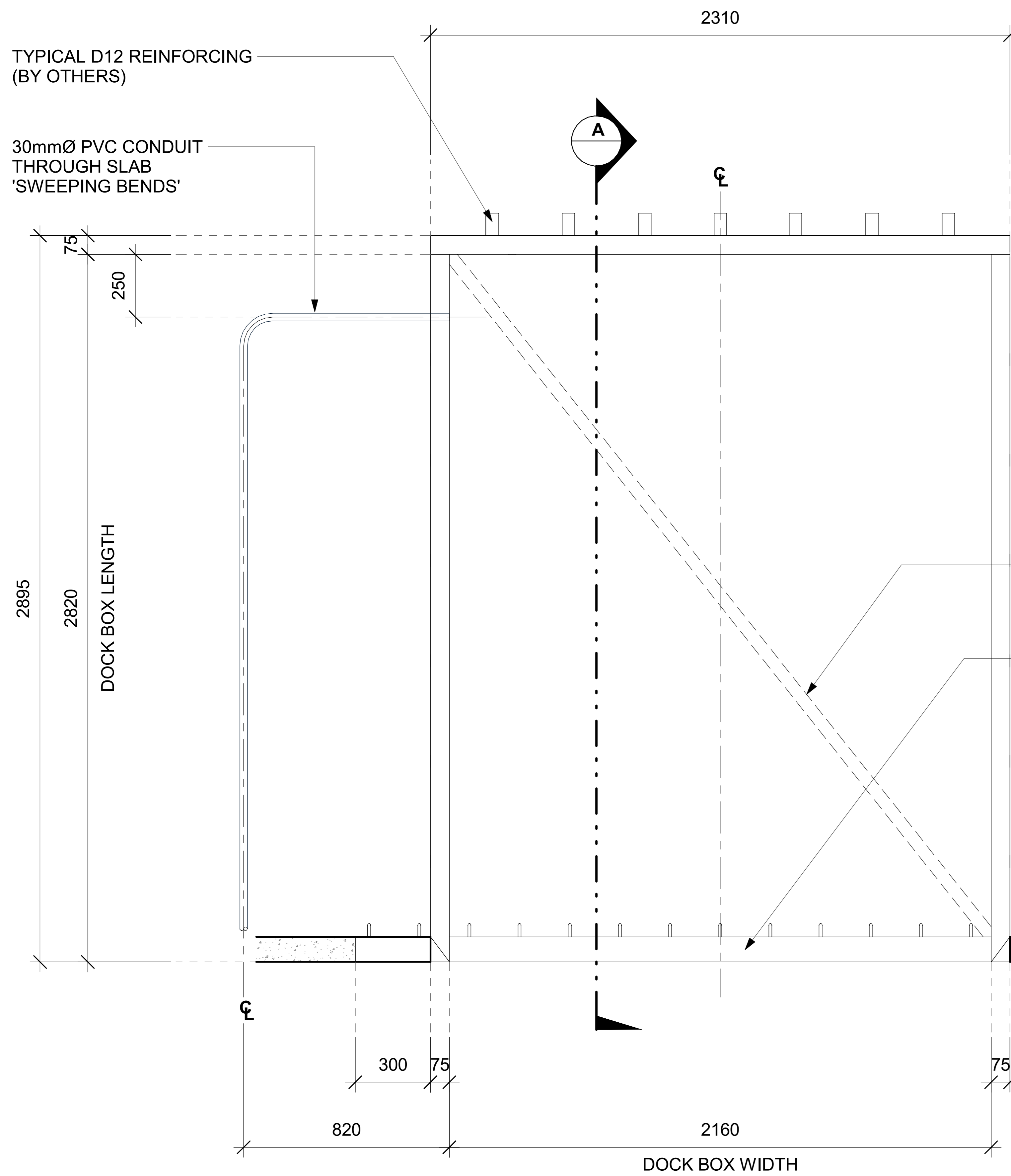

4 **3D VIEW 1**

SCALE: N.T.S.

TEMPORARY BRACE TO ENSURE UNIT IS SQUARE

FRONT FACING ANGLE PRECAST TO PIT FLOOR SLAB PRIOR TO DOCK PIT FORMING KIT INSTALL
HOT DIP GALVANISED 100 x 100 x 10mm WITH D12 REINFORCING TAGS

3mm STEEL SHEET FABRICATION HOT DIP GALVANISED FINISH

6 **3D VIEW 3**

SCALE: N.T.S.

3mm STEEL SHEET FABRICATION HOT DIP GALVANISED FINISH

FRONT FACING ANGLE PRECAST TO PIT FLOOR SLAB PRIOR TO DOCK PIT FORMING KIT INSTALL
HOT DIP GALVANISED 100 x 100 x 10mm WITH D12 REINFORCING TAGS

3 **SECTION 'A' VIEW**

SCALE: 1:10 MTS.

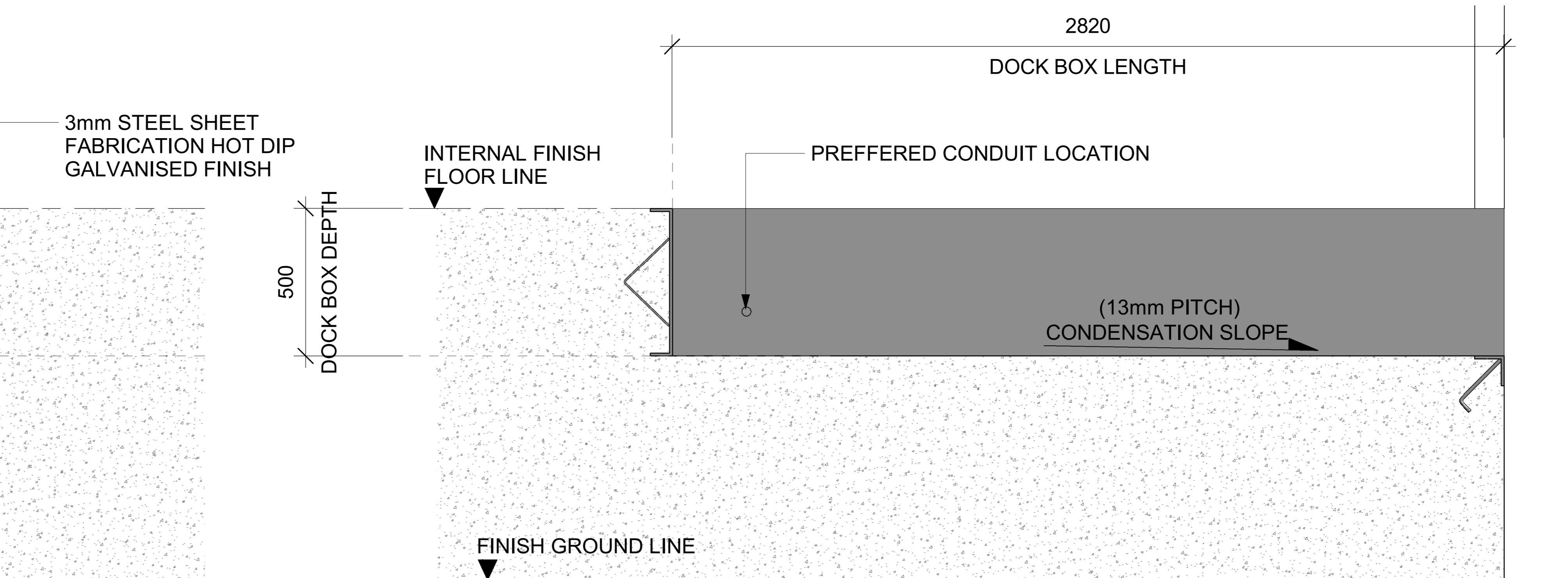

5 **3D VIEW 2**

SCALE: N.T.S.

12.5mmØ HOLES FOR SCREW BOLT FIX TO BASE SLAB

TITLE:	
ULTI DOCK PIT FORMING KIT	
(10' L x 7' W DOCK LEVELLER)	
(2820mm L x 2160mm W DOCK LEVELLER)	
SHEET NO. :	DATE :
1 OF 1	JUNE 30, 2021

DRAWING NUMBER :			
DOCKBOX-10L7W-001			
APPROVED BY :		J.PRESTIDGE	
DRAWN BY :		J.ENRIQUEZ	
SCALE :	As indicated	SHT. SIZE :	A0
*All dimensions are in millimeters unless otherwise specified			