

# 2400 Series Swing Door

## PVC TRAFFIC DOOR



These doors are a long-proven solution for very busy openings, allowing constant personnel access through the door in both directions. The clear-view PVC panels enhance safety and provide an effective environmental barrier to control noise and contamination.

### Crash Through

The very robust construction of these doors allows both forklift traffic and personnel to pass through in either direction at any time. These 'crash doors' swing both ways and are engineered to withstand the kind of punishment that traditionally hinged doors simply can't cope with. Heavy-duty spring mechanisms continuously reset the door to its closed position at all times, and impact release shear pins ensure no damage to the door or surround if the frame is accidentally impacted by forklift traffic.

### Commonly installed in:

- Supermarkets and Retail
- Food preparation areas
- Hospitality and Kitchens
- Health and Medical
- Laboratories
- Washroom and amenities
- Commercial Laundries
- Logistics Facilities

### Aesthetic Screening

The 2400 series door has anodised aluminium frames and a selection of attractive optional solid colour choices that can be added to the main PVC panels providing appropriate privacy screening of warehouse or production areas from areas accessible by the general public. Customised signage is available to request, such as "staff only access" or similar.

### Long-life

Due to the very robust hardware, including lubrication-free nylon bearings, these doors endure constant harsh usage. No other double acting door can withstand the same constant impact of heavily-trafficked openings. These doors outlast more traditional materials such as timber door leaves by as much as 5 times!

### Environmental Control

The door leaves' spring-loaded operation ensures only the minimum required area for traffic pass-through is used. This provides significant benefits in controlling the respective environments either side of the doors and ensures maximum noise reduction, HVAC efficiency and vermin and pest protection.

### Cleanability

Every component of the 2400 series doors is easily cleanable ensuring hygiene and visual aspects are easily maintained. Stainless steel spring systems are also available which allow full wash down of the doors should this be required for safety compliance.



## TECHNICAL SPECIFICATIONS

|                       |   |
|-----------------------|---|
| Standard Sizes        | up to 2200mm H x 2000mm W (Double Leaf)<br>up to 2200mm H x 1000mm W (Single Leaf)  |
| Maximum Sizes         |   |
| Double Leaf           | up to 2400mm H x 2400mm W<br>up to 2800mm H x 1360mm W<br>up to 3200mm H x 1120mm W |
| Single Leaf           | up to 2400mm H x 1280mm W<br>up to 2600mm H x 980mm W<br>up to 2700mm H x 830mm W   |
| Maximum Opening Angle | 90°   |

## STRUCTURE

|        |                                 |
|--------|---------------------------------|
| Frames | High Tensile Anodised Aluminium |
|--------|---------------------------------|

## SPACE REQUIREMENTS

The minimum structural requirements for door openings are 90mm depth of standard framing. All jamb trims or flashings e.g. stainless-steel capping is to be provided by others prior.

Complete door opening must be level, plumb and square.

Floor must have no incline within entire swing of door, or order to highest point of finished floor.

## DIMENSIONS

### Double Leaf

NOTE:  
ORDER DOORS BY CLEAR  
OPENING DIMENSION  
REQUIRED

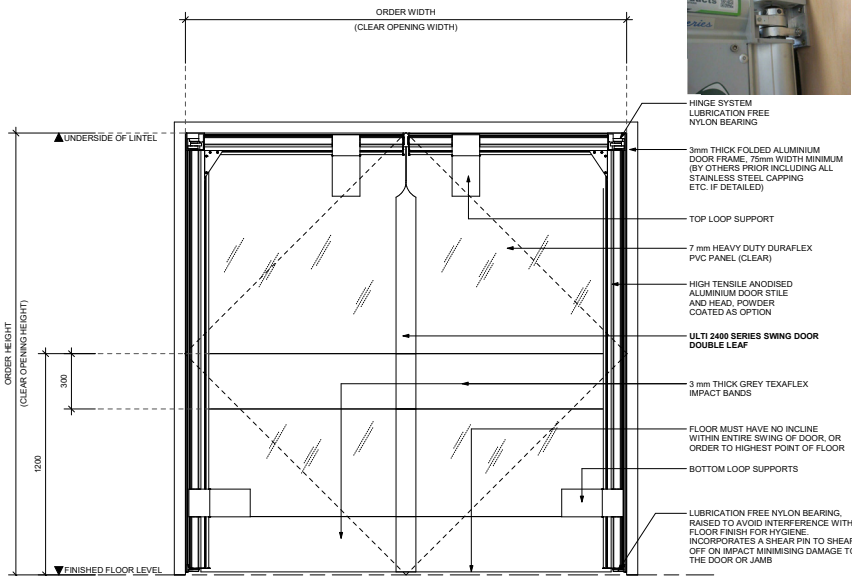
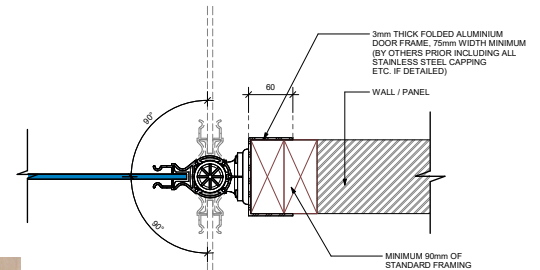
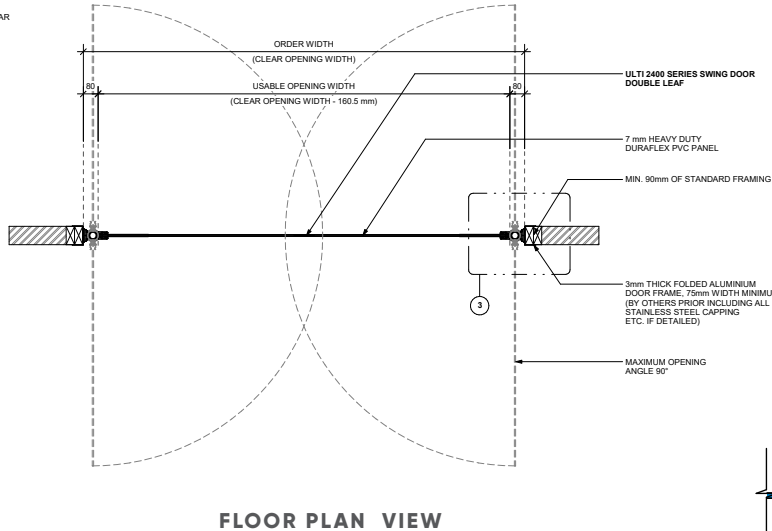

## PANEL

|                   |                             |
|-------------------|-----------------------------|
| Material          | 7mm Heavy Duty Duraflex PVC |
| Bearings          | Lubrication Free Nylon      |
| Knock Out Release | Shear Pins                  |

## STANDARD INCLUSIONS

2 rows 300mm impact bands across door width (grey) at ground level and 900mm Heavy-duty support bands for door leaves, 2x per leaf

## WARRANTY

12 Months or 100,000 Cycles  
\*Std Warranty terms and conditions apply

## OPTIONAL INCLUSIONS

- 2 rows 300mm impact bands across door width (clear, black, or blue)
- Texaflex coloured PVC privacy panel, max 1400mm high (grey, black and blue)
- Stainless steel spring upgrade (required for washdown areas)
- 4000 series aluminium frame where required for extra support (alters frame dimensions)
- Additional frame pivot for opening angles over 100° (alters frame dimensions)
- Custom colour powder-coated frames
- Double-sided laminated signage to custom requirements
- Heavy-duty support bands for door leaves, 1x per leaf (pedestrian only)